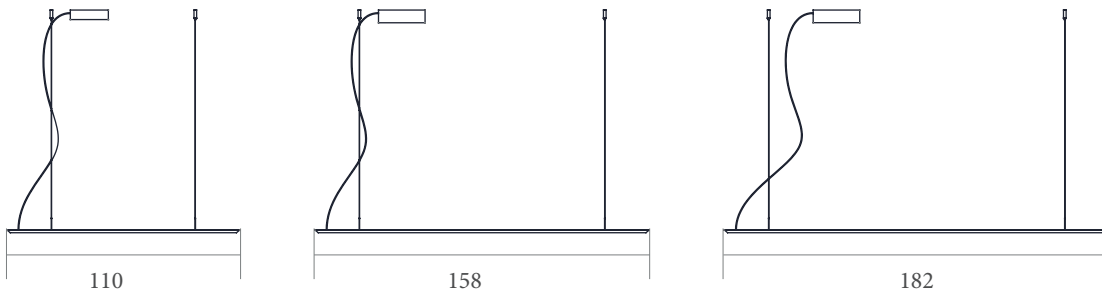

**LINEAL** Gabriel Teixidó

Mounting information

Colgante | Pendant lamp

**INSTALACIÓN**

1. Fijar los soportes de la lámpara y la caja en el techo
2. Colgar la lámpara, ajustar la altura con los reguladores y cortar el tensor restante.
3. Conectar el transformador a la instalación sin alimentación.
4. Instalar los cables del colgante a través de los pasa cables manteniendo la polaridad, (Rojo/Negro).
5. En caso de error, no se encenderá y deberán invertir el conexionado.

**INSTALLATION**

1. Affix the ends of the lamp and the holder on the ceiling.
2. Hang the lamp, adjust the height with regulators and cut the remaining tensor.
3. Connect the transformer to the installation without power supply.
4. Install hanging wires through cable grommet maintaining the polarity (Red/Black)
5. If there is an error, it will not be light up, please reverse the wiring.

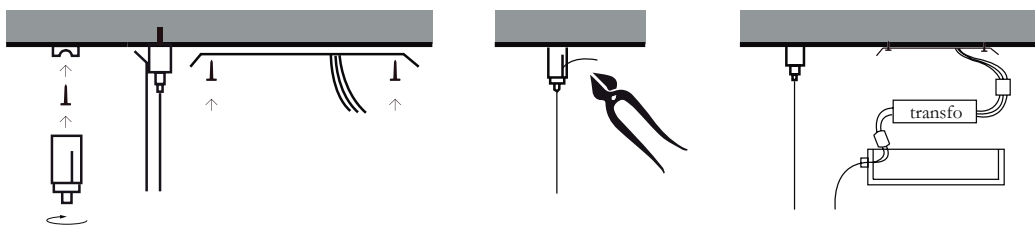

Reguladores recomendados por el fabricante

| MANUFACTURER | DIMMER MODEL               |                   |
|--------------|----------------------------|-------------------|
| LUTRON       | SKYLARK SF-12P-277         | (277VAC/60Hz)     |
| LUTRON       | DVF-103P-277               | (277VAC/60Hz)     |
| JUNG         | Licht-Management 225 TDE   | (230VAC/50Hz)     |
| JUNG         | Licht-Management 225 NV DE | (230VAC/50Hz)     |
| BERKER       | Tronic-Drehdimmer 286710   | (230-240VAC/50Hz) |
| CLIPSAL      | 32E450UDM                  | (220-240VAC/50Hz) |
| CLIPSAL      | NO 32E450TM                | (220-240VAC/50Hz) |
| CLIPSAL      | NO 32E450LM                | (220-240VAC/50Hz) |
| CLIPSAL      | Cat 400T                   | (230-240VAC/50Hz) |

Conduction angle: 30 degrees(min.) / 180 degrees (max.)