

FLOS

F1490009 Glass

Mini Button

Designed by Piero Lissoni, 2005



Halogen - 25W

Wall or ceiling fixture providing diffused lighting suitable for indoor and outdoor use. Silicone elastomer dust and waterproof seal. Die-cast aluminum lamp body and wall fitting. Diffuser available in opaline glass (IP40) or polycarbonate (IP44).

Are you a professional and your project needs consulting and support?

BOOK AN APPOINTMENT

Main specifications

EAN	8059607015179
Mounting	Ceiling and wall surface
Environments	Indoor Outdoor wet location
Light Source Type	Bulb
Lamp category	Halogen
Lamp holders	G9
Iicos	HSGS
Number of heads	1
Power (W)	25

Physical

Colour	Glass
Net weight (kg)	0.66
Package height (mm)	70
Package width (mm)	190
Package length (mm)	205
IP internal	44

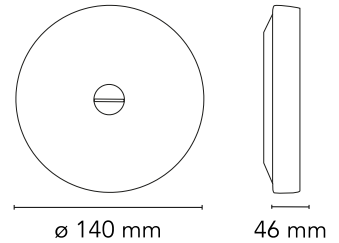

Download

Mounting instructions [↓ PDF](#)
Spare Parts [↓ PDF](#)



Schematic light drawing

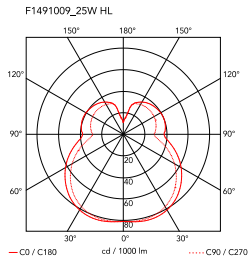

Photometric

Lighting type	Total
Light distribution	Roto symmetric

Electrical

Insulation class	I
Frequency (Hz)	50/60
Main voltage (Vac)	220-250
LED voltage Vf (Vdc)	null
Dimmable	Yes
Dimming interface	Remote Dimmable (Dimmer Not Included)
Batteries inside	No
Charging min time	No

Bulbs

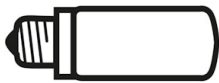

NOT INCLUDED

RF28425

LED BiPin Lamp G9 3W 2700K
Non Dimmable



NOT INCLUDED

RF26520

LED Lamp 2W 240lm G9 220-
240 2700K T13 Non Dimmable

Spare Parts

- | | | |
|-----|-------------------------|-----------|
| 01. | G9 5600 lamp holder | RF12818 |
| 02. | Glass diffuser assembly | RF1490109 |

DOWNLOAD

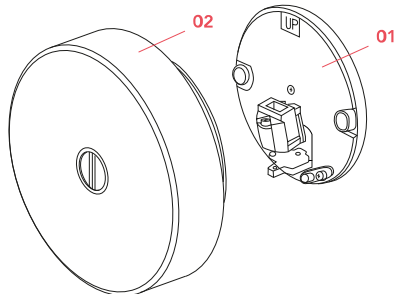



RF12818

G9 5600 lamp holder



RF1490109

Glass diffuser assembly